

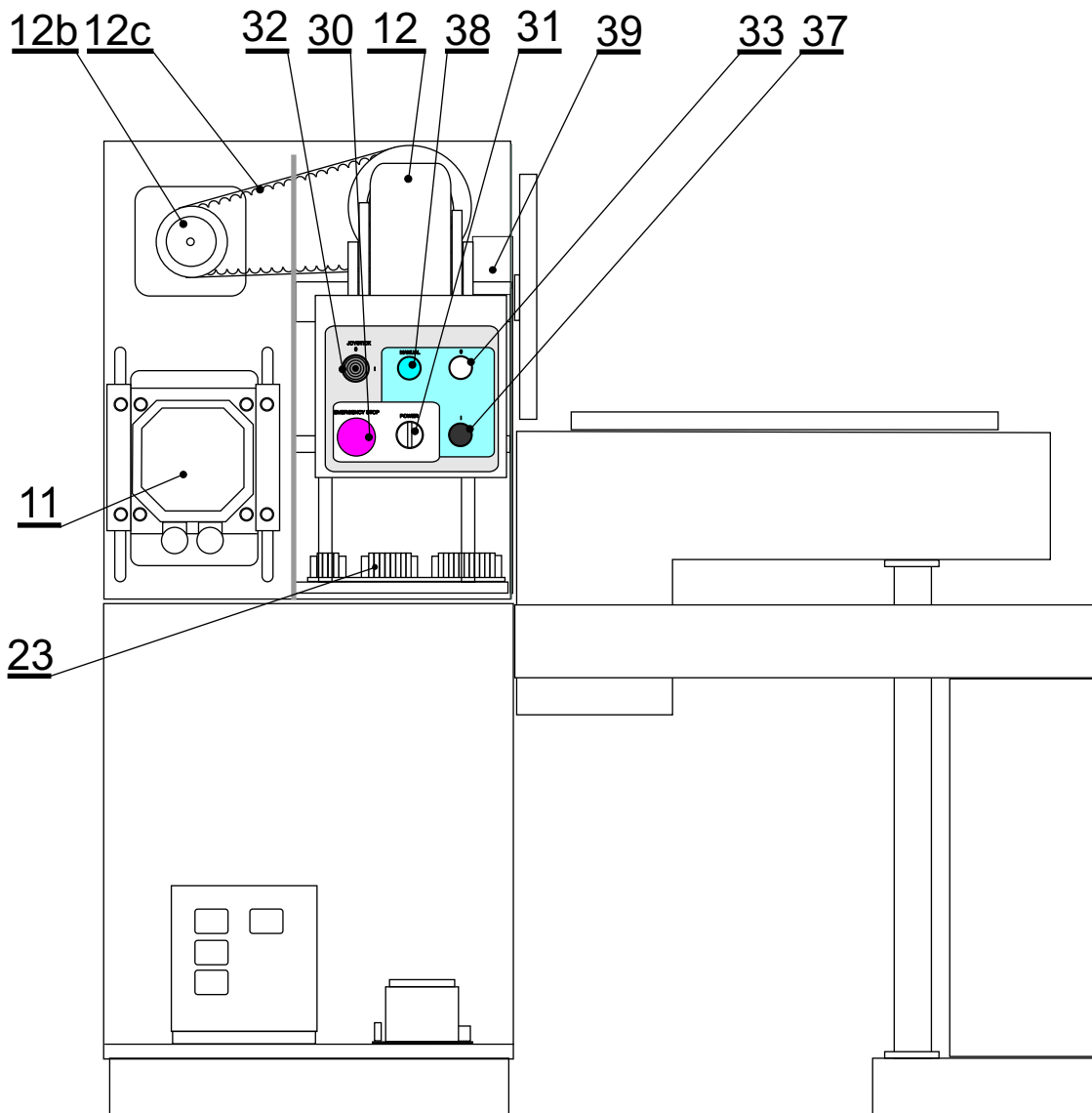

SPARE PARTS ERN 200G



- 11. Servomotor
- 12. Gearbox
- 12b. Timing gear
- 12c. Timing belt
- 23. Connector
- 30. Emergency stop
- 31. Stand - by switch
- 32. Joystick
- 33. Start - button
- 37. Stop - button
- 38. Manual - button
- 39. Opto sensor

- TGT5 -1350-30-560
- W 110 U-10HS-B3
- 8MGT - 880 -25
- 32-8M-50/6F
- TA 048 68
- TA 048 72
- TA 048 74
- TA 048 76
- TA 026 41
- TA 026 42
- TA 026 43
- QMT42VN6FF500-1000



SPARE PARTS ERN 200G

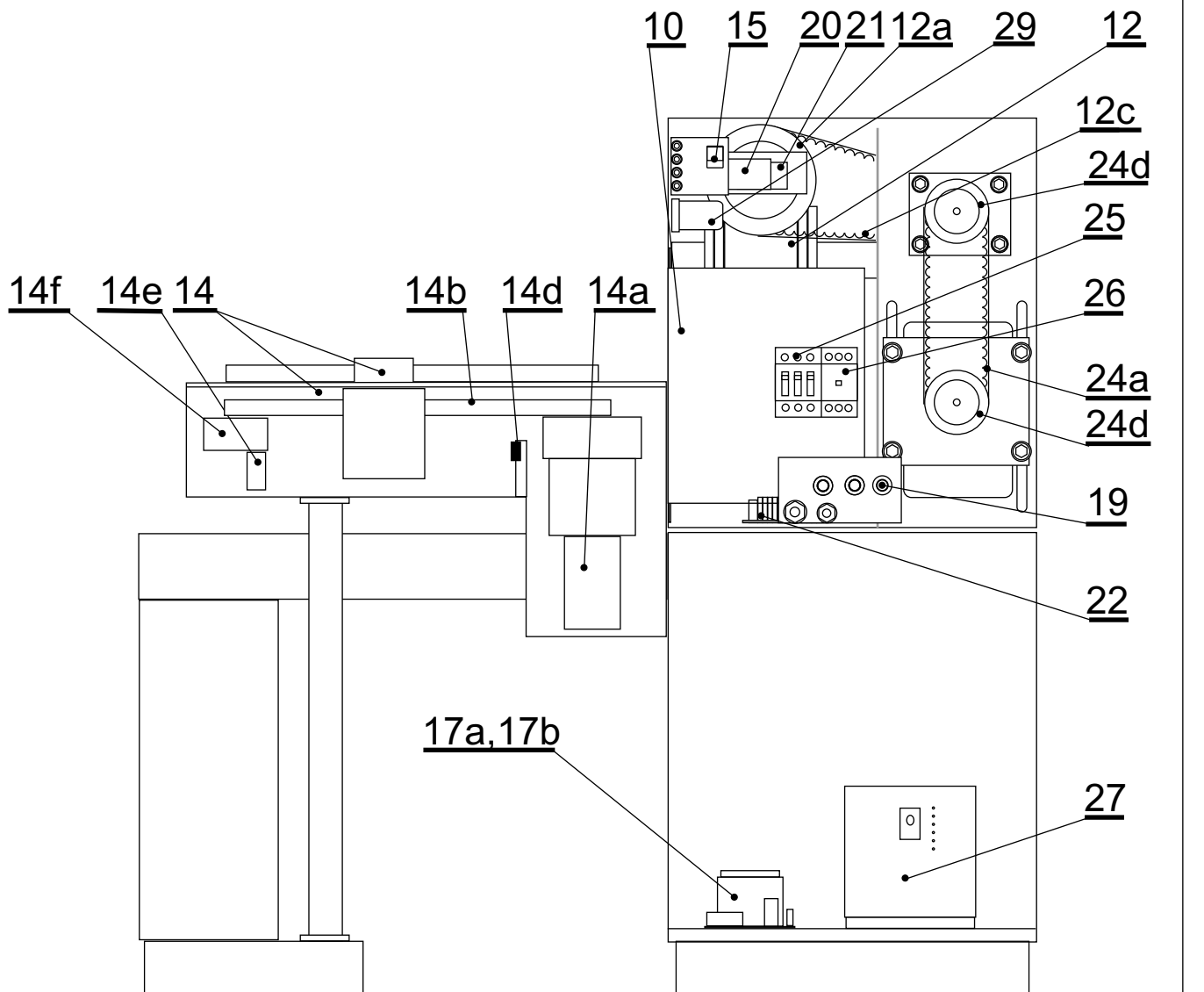

- | | | | |
|-------------------------|-------------------------|-------------------------|--------------------|
| 10. AC servo amplifier | Servostar 712 | 20. Servo power supply | TK 000 56 01 |
| 11. Servomotor | TGT5-1350-30-560 BS1 | 21. Servo driver | TGA-24-9/20 |
| 12. Gearbox | RT-120-10A | 22. Connector | TA 048 70 |
| 12a. Timing gear | 64-8M-20/6WF | 24a. Timing belt | 5MR-650-25 |
| 12c. Timing belt | 8MGT-880-25 | 24d. Timing gear | 36-5MR-25/6F |
| 14. Wire guide unit | NB SGL35A- cart | 25. A.C.circuit breaker | RSI-25-40-A230 |
| | NB 00133 932-guide | 26. Relay switch | LPN-16C-3 |
| 14a. Servomotor | TGH3-0160-12-24/T1BK-2M | 27. Back - UPS | Smart UPS SUA 750I |
| 14b. Timing belt | 32T10 | 29. Relay | RP 700 PC/230V3P |
| 14d. Microswitch plate | TK 0 057 | | |
| 14e. Limit switch | XCK3 212 1G11 | | |
| 14f. Ball bearing | 6003 2ZR | | |
| 15. Connector for pedal | TA 026 44 | | |
| 17a. Power supply unit | TK 000 36.00 - ST 106 | | |
| 17b. Power supply unit | TK 000 36.00 - ST 107 | | |
| 19. Fuse case | SI-HA 125000 | | |



SPARE PARTS ERN 200G

GEAR 150 rpm

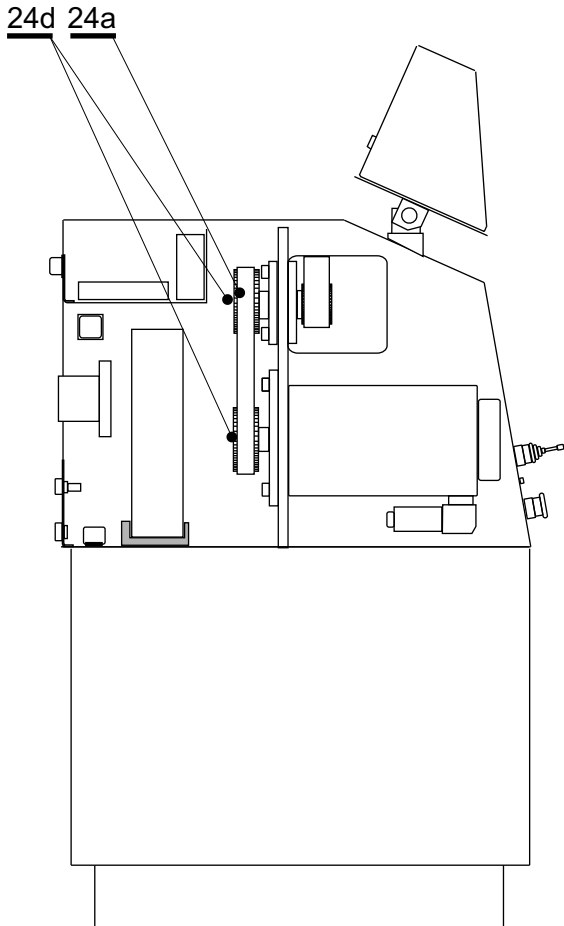

GEAR 75 rpm

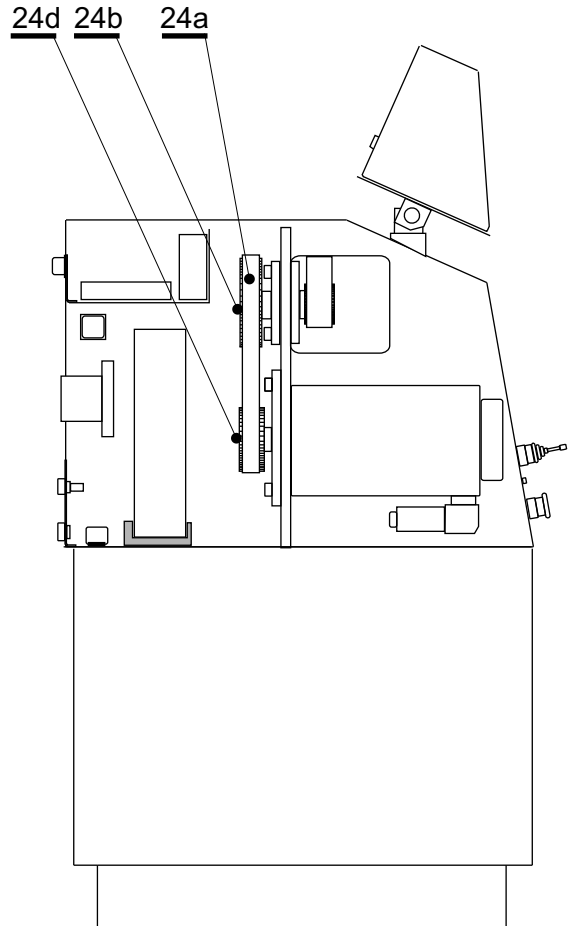

- 24a. Timing belt
- 24b. Timing gear
- 24d. Timing gear

- 5MR-650-25
- 72-5MR-25/6W
- 36-5MR-25/6F



SPARE PARTS ERN 200G

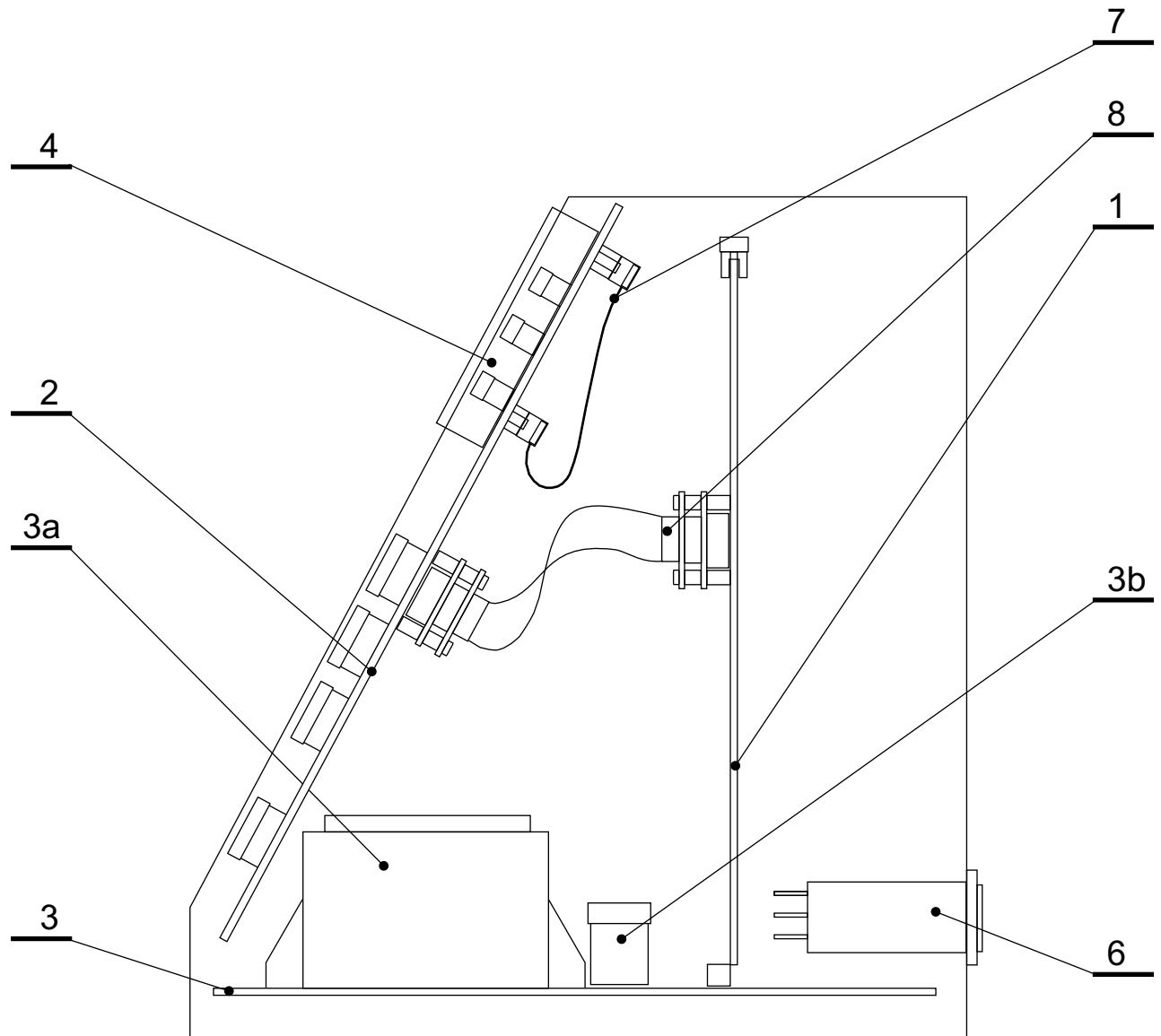

- | | |
|--------------------------------|----------------------|
| 1. PCB 1. | TK 000 50 - 02 |
| 2. PCB with keyboard | TK 000 60 - 01 |
| 3. Backplane | TK 000 51 - 04 |
| 3a. Mains transformer | TRZ 007/ST 39 - 01 |
| 3b. Fuse for bluetooth adapter | 160mA/250V |
| 4. Display | PLANAR EL.240.128.45 |
| 6. Mains filter | ETI 39.19.160 |
| 7. Connector cable - display | TA 032 00 |
| 8. Connector cable -RS 232 | TA 032 01 |